

SONY®

Getting Started

US



Network Media Player

NSZ-GS7/NSZ-GX70
(NSZ-GX70 is only for the US)

Google TV™ 

Launch the online “Help Guide” (page 14) to find out more about your player.



Getting Started:

POWER
TV/AMP **ON/STANDBY**
Turns the player on or off.

Control connected devices with one remote:

- To use this function, make sure that the player is on.
- For details on the settings for the remote code, see "Help Guide" (page 14).

TV/AMP **ON/STANDBY (TV/AMP)**
Turns on or off the TV/AV Receiver.

INPUT **INPUT (TV/AMP)**
Changes inputs.

GUIDE **GUIDE***
Display the TV Program Guide screen of the connected Set Top Box.



DVR **DVR***
Display the DVR (Digital Video Recorder) list of recorded content.

TV **TV***
Switches to the Live TV mode and displays the picture of the connected Set Top Box.
* Press  (HOME) to return to the Home screen.

To control your AV Receiver:

Fn **Function**
Keys with orange dots will be available for use in providing AV Receiver control when the Function indicator is on.

Volume/Channel Control (on the side):

-  **VOLUME**
Turns the volume up or down.
-  **MUTING**
Silences the sound

-  **CHANNEL (for the Set Top Box only)**
Selects the next (+) or previous (-) channel.

Basic Control:



Displays two pictures, such as a TV program and a website, on the screen, simultaneously (page 11).



Opens the Home screen (page 6). Press this button to return to the Home screen from the screen of a connected device such as a Set Top Box.



Returns to the previous display, or exits the application.



Displays special options associated with each feature.

Playback Control:

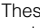
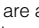

These keys are available when videos, music, or photos are playing. The  and  keys work only when they are held down continuously (not tapped).



PUSH OPEN



Operate intuitively with a touch-pad:

You can click, scroll, drag and drop, and zoom in/out with your remote.

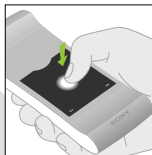

Click

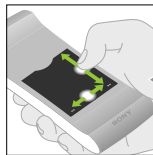

Scroll vertically & horizontally

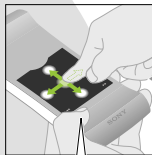
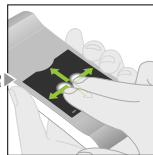

Drag & drop

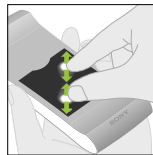
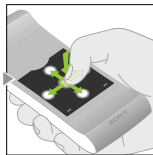

Zoom in/out

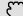

Press and hold the  button to drag an item, then release the button to drop it.

See "Help Guide" (page 14) for more gestures and detailed explanations.

Using the special keys:



Search

Type your query in the Quick Search Box, and the player will suggest content from various media.

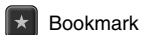

Bookmark

Bookmarks your favorite content.



Other keys:



Function

Keys with orange markings will be available when the Function indicator is on.



Shift

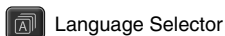

Language Selector

When using in the dark:



Turns the backlight on and off*.

*You can set the backlight to be turned on and off automatically from "Settings" (see "Help Guide" (page 14) for details).

Please note that battery power drains quickly when using this function.

Control with motion:

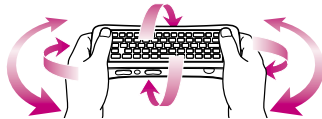

Motion control is available when you are launching compatible applications.

Home

Access each feature from here

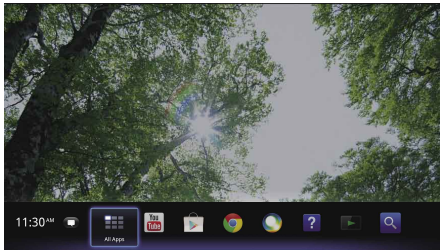

You can access various content and applications from the Home screen. The Home screen contains Notifications, All Apps, and shortcuts to select applications and websites.



The Home screen can be customized to suit your preferences. You can arrange the Home menu, add widgets to the Home screen, and change the wallpaper.





Google Chrome

Browse websites

This player uses Google Chrome™ as its web browser. You can access all your favorite websites with the Google Chrome web browser.



Websites can be bookmarked, and you can access bookmarks from the browser menu. You can also add a shortcut of a website to All Apps.

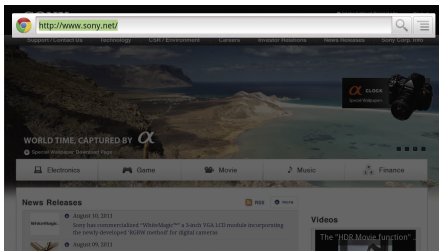



All Apps

Enjoy installed applications

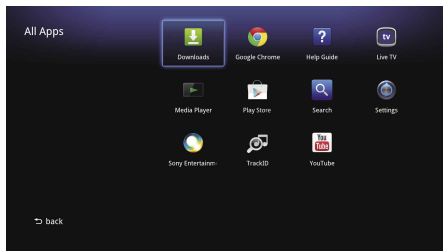

You can access all applications installed on your player from the All Apps list. You can launch applications including Live TV, Media Player, and Help Guide from here.



Applications or bookmarks in the All Apps list can be uninstalled, hidden, or removed, depending on what you select.

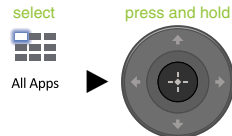

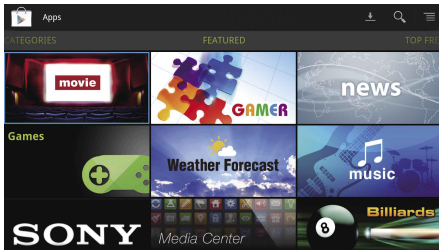

Google Play™ can provide you with additional favorite applications.

You can download applications and instantly use them on your player. Downloaded applications are stored in All Apps.

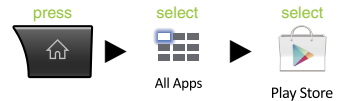

You can check the progress of downloads.





Media Player

Play files from USB devices/internal memory

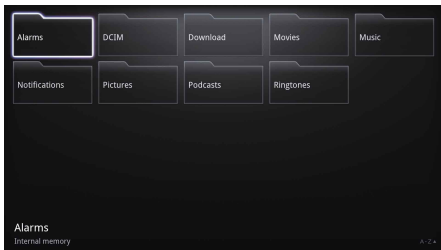

You can play back audio/video/image files stored on a USB device (for details, see the Help Guide (page 14)), using Media Player.



You can select a device and change its settings.





Picture-in-Picture

Enjoy applications and websites while watching TV

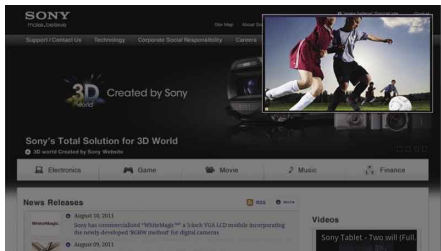

PIP (Picture-in-Picture) is a feature that allows you to display the TV screen in a smaller window (a sub window). For example, you can browse the Internet on the full screen, while watching a TV program in a sub window at the same time.



Live TV

You can change the size and position of the sub window.



Live TV

This function is available only when you watch pictures output from a Set Top Box or DVR.



Settings

Customize your player

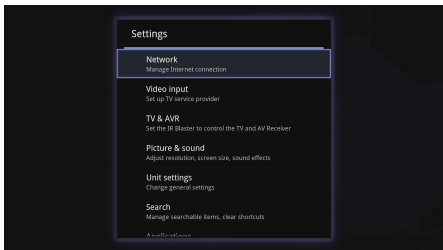

You can change various settings for your player from the Settings menu.



You can also access the Settings menu from the menu that appears when the Home screen is displayed.





Media Remote

Use your smartphone or tablet
more effectively



Download the free “Media Remote” app to your Android™ phone, Android™ tablet, or iPhone.



Scan for Android



Scan for iPhone

Using Media Remote, you can use the device as a remote for the player, search for music that is being played, or send websites displayed on the device to the TV.



Help Guide

Learn more about your player

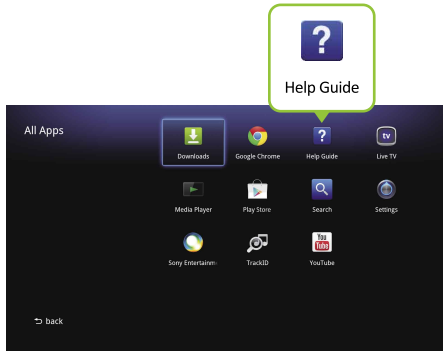

The Help Guide gives you detailed information on how to use the player.

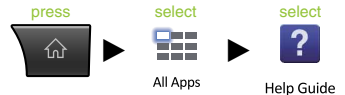

You can also access the Help Guide from a PC browser or smartphone.

<http://www.sony.net/helpguide/r/networkplayer/>



© 2012 Sony Corporation
Printed in China
4-421-773-12(1)



Sony Customer Support

USA: <http://esupport.sony.com/> | 1-800-222-SONY

Canada: <http://esupport.sony.com/CA/> | 1-877-899-SONY

Please Call Before Returning the Product to the Store

Trademark Information

- Google TV, Google Chrome, Google Play, Android and their respective logos are trademarks of Google Inc.
- iPhone is a trademark of Apple Inc., registered in the U.S. and other countries.
- Other system and product names are generally trademarks or registered trademarks of the manufacturers. ™ and ® marks are not indicated in this document.

Screen images, operations, and specifications are subject to change without notice.